

Safety Track

ST- 401/801 Standard Installation Guide



A detailed guide on how to install your new fleet management system

Version 1.8 1/2022

Table of Contents:

1. What's in the box.....	pg.3
2. Standard Installation Steps.....	pg.4-8
3. Verification.....	pg.8

This is a step by step guide that will walk you through installing the UCIT LIVE HD 4/8 Channel Camera System. Basic wiring experience and knowledge is required at the minimum. Please follow each step, otherwise your system may not work properly. If you have any questions regarding the installation of this system contact Support at 734-325-6060 or Support@SafetyTrack.net. We are always available for questions when needed. Please take your time, take caution and Enjoy!

Notes and Precautions

Please make sure power connections are clear to you before you make the connection.

DO NOT WIRE TO ONLY CONSTANT POWER

Please Follow this Guide STEP BY STEP do not skip around.

It is highly recommended to have a professional installer install these units.

Keep DVR System away from liquids, heavy dust and dirt, fire and extreme temperatures.

If possible keep the equipment in a well ventilated area.

Review packing list or “whats in the box” to make sure you have everything.

NOTE: Any modifications to the device or software outside of company standards without company approval are not a responsibility of Safety Track and will void the warranty.

1. What's in the box?:

- ST-400/800 series MDVR with chosen memory capacity pre-installed
- Drill mount MDVR wing attachments
- Power harness
- Accessory harness
- 4G antenna
- GPS antenna
- Remote
- Remote IR extension
- 3M Velcro mounting strips
- Microphone (If applicable)



*Cameras will be boxed separately as well as any accessory such as a monitor.

Inside each camera box you will find:

- HD camera
- Mounting hardware and or 3M mounting tape
- Camera adjustment tool



* Additional accessories such as a monitor will be also boxed separately and will contain everything you need for setup with your MDVR.

Installation App and Fleet: (Required)

Be sure to download both, our Installation Asset app and Fleet app below. Available on the Apple App store and Google Play Store.

Safety Track Asset App:

Apple: (Tap here)

Android: (Tap here)

Safety Track Fleet App:

Apple: (Tap Here)

Android: (Tap Here)



These Tools Can Help!

- Volt Meter
- Wire Crimpers
- Wire Strippers
- Electrical Tape
- Zip Ties
- Self Tapping Screws
- Auto Trim Removal Tool

2. Standard Installation Steps:

Step 1: Placement

Locate where you intend to mount the MDVR. A common location is inside the glove compartment. Keep in mind that all cameras, antennas and accessories will be powered by the MDVR.



Step 2: Locate Power Source

If you have 12V wiring experience you probably already have a location in mind. It is common to tap into the ignition harness under the steering wheel. You can also tap into most fuse panels if you have the means to do so. Refer to the owner's manual in the vehicle you intend to do the installation to find these locations. Constant 12V power, Ignition/switch power and ground are required.

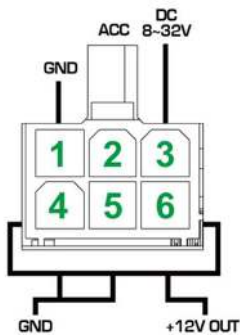

1. Ground (Black)
2. Ignition (Blue)
3. Power (Yellow)
4. N/A
5. Microphone Ground
6. Microphone Power

DO NOT WIRE TO ONLY CONSTANT POWER

Make the connection then attach 6 pin to DVR.

Step 3: Mounting Cameras and Accessories

Safety Track Appointed Professional Installers:

You will have been given direction as to which camera type goes where on each vehicle. Please follow as instructed, if any complications arise contact support at 734-325-6060 or support@safetytrack.net

Valued Customers:

Camera mounting locations should have already been discussed with your Sales rep. We have recommended mounting locations based on each model of camera we carry. These of course can be deviated from but are proven most useful depending on your needs.

See below for camera and accessory connections at back of MDVR.

Camera Connections:

V - Video Output

A - Audio Output

1 - Camera 1 Video Input

2 - Camera 2 Video Input

3 - Camera 3 Video Input

4 - Camera 4 Video Input



See the image to the right. When connecting camera extension to MDVR pig tail or camera to extension. Notice an arrow on both the male and female end. These must be lined up before connecting. Once connected, twist and tighten the adjuster to secure the connection. Further secure the connection by using the provided water seal by wrapping the connection. (Fig. A) Use electrical tape to complete the connection. (Fig. B)

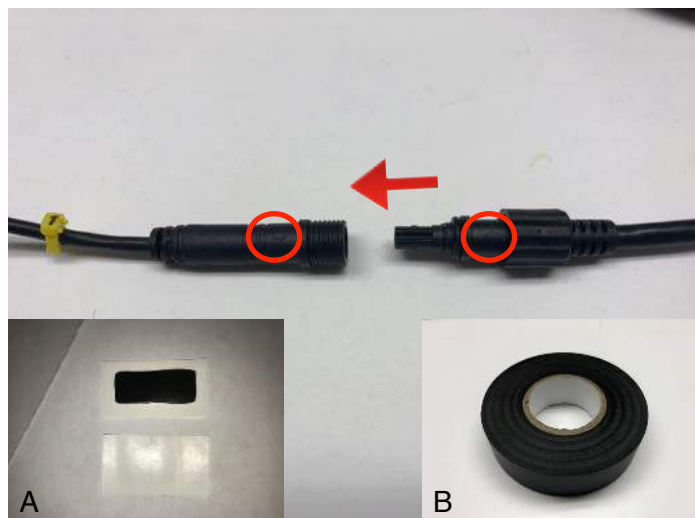

See below for recommended camera mounting locations based on camera type.



ST-10C:

Designed to be placed on the windshield and face forward toward the road. Two adjustment points on this camera, one to tilt and one rotates the cam.



ST-11C:

Designed to be placed on the windshield and face in toward the occupants. One adjustment point on this camera, at the base to adjust tilt/angle.



To the left is an example of the most common windshield placement for the 10C and 11C cameras that are included with each package.



ST-12C:

Designed to be placed on the exterior of the vehicle for a rear view. Two adjustment points on this camera, both sides of the camera will adjust the tilt and angle of the camera.



ST-13C:

Designed to be placed on the interior of the vehicle and face occupants. Three adjust adjustment points at the base removes casing to allow for angle adjustment.



ST-14C:

Designed to be placed on the exterior of the vehicle for a side or rear view. One adjustment point at the rear where screw is removed to remove casing to adjust angle.

Accessory Connections:

A - GPS Antenna

B - 4G Antenna

C - Accessory Harness (If applicable)

The GPS antenna (A) and 4G antenna (B) should be mounted on the upper or lower, far right or far left side of the windshield. This will ensure a great signal with a clear view to the sky.

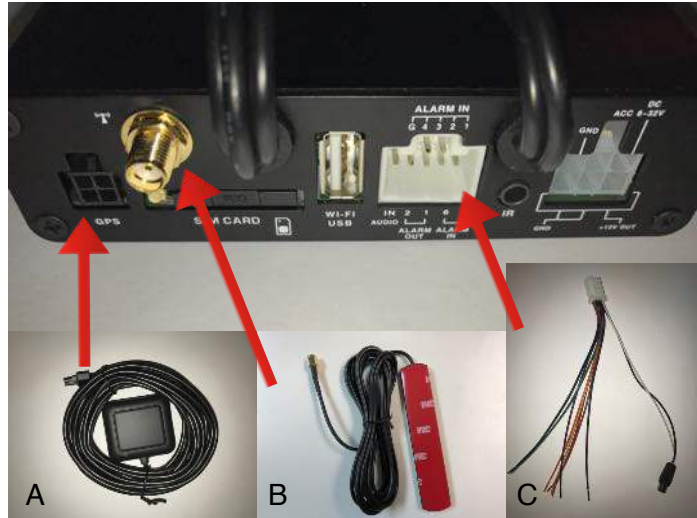

As for the Accessory Harness (C) this is most commonly used when there is a microphone involved with the installation. See below for directions on how to install the microphone.

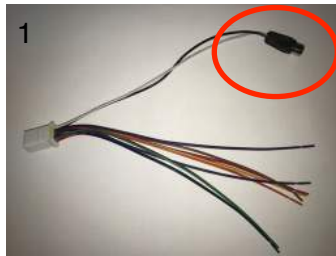

1 Find the Accessory Harness RCA (Female) White Wire Only



2 Find the Extension Yellow RCA (Male) and Red plug (Female)



3 Plug in the Yellow RCA (Male) from Microphone



4 Find the power



5 Plug the Black Plug (Male) from the Power Harness into the Red Plug (Female) on the Microphone Extension



6 Find the Microphone White RCA (Female) and Red Plug (Female)



7 Plug Yellow RCA (Male) from Microphone Extension into White RCA (Female) on Microphone



8 Plug Red Plug (Male) from Microphone Extension into Red Plug (Female) on Microphone

Place the Microphone so that it is visible and in an optimum position to get the best clarity. Pictured right is a recommended placement example. Driver side A-Pillar, this way it is near the driver.



Step 4: Verification:

Ensure proper connection by checking the lights on the front face of the MDVR. It may take a few seconds for lights to appear once you connect power.

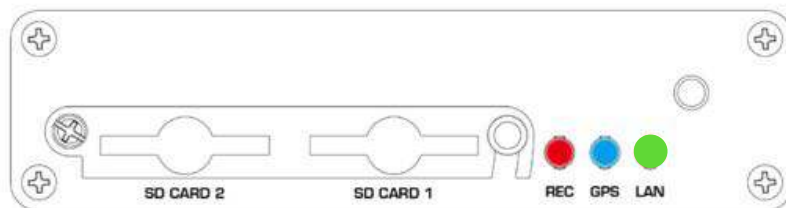

Red - Recording (Will blink when recording properly).

Blue - GPS (Solid blue when location is being transmitted).

Green - LAN/4G (Solid when connected to 4G LTE network)

*****NOTE***: Further verification is required with our support team please call [734-325-6060](tel:734-325-6060) to verify proper function!**