



# Safety Track

## 7" Monitor

### Installation Guide



A detailed guide on how to install your monitor and connect it to your Safety Track solution.

## 1. Remove from Box

Remove everything from the box and unwrap the contents of the box. Once the Screen is unwrapped, notice the two push tabs on both sides of the screen (pictured right). Push these tabs and pull away the plastic bracket/ case as this is not needed.



## 2. Tighten Wheel

Remove the Panavise Mount from the box. Tighten the silver wheel by twisting clock wise to give room to mount to the monitor.

Notice there are two other adjustment points on the Panavise mount as well.



## 3. Attach Monitor to Mount

On the back of the monitor, line up the groove with the mounting point on the Panavise.

Once in the desired position, twist the silver adjuster wheel counter clockwise to tighten firmly against the monitor.



## 4. Mount

Once you have a desired mounting location chosen, mount with self tapping screws or similar.

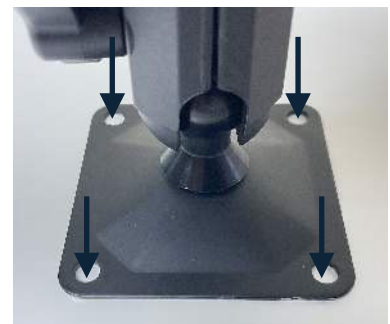

## 5. Connect to Power

Next attach the power cable coming from the monitor to the power harness. (Pictured here) Line up the groove on each end and make the connection. Once pushed together, use some electrical tape to ensure a maintained connection.

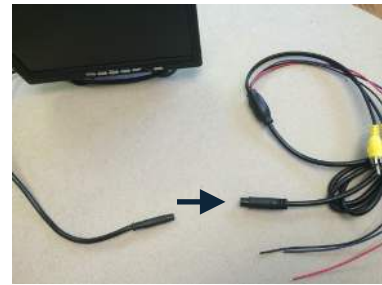

## 6. Connect Yellow Cable

Connect the yellow cable from the harness and insert it into the yellow video (V) Pigtail from the MDVR.

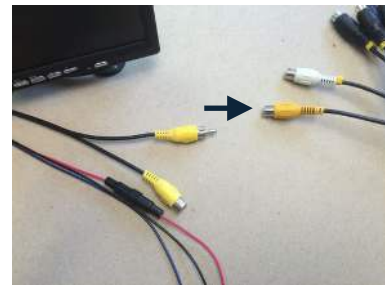

## 7. Ground

Hardwire the monitor to an ignition source and ground.

Red: Ignition  
Black: Ground  
Blue: Unused

The unit will power on when the vehicle is started. Monitor by default is assigned to Camera 1. Make sure if you are using this monitor as a backup camera view, then plug the back up camera into camera port 1 on the MDVR.

